

**INSPECT FOR DEFECTS PRIOR TO ASSEMBLY!
NO CREDIT WILL BE ALLOWED ON ASSEMBLED FRAMES!**

- Assembly wedges may be different lengths or the same length. You must compare the assembly wedge lengths to the depth/length of the wedge routes in the frame corners.
- Assembly wedges are installed pointed end first.
- When applying glue, it should be spread evenly so the entire cut end of each 45° piece is coated. A damp rag will clean off glue that may have gotten onto the front of the frame. Allow at least 3 hours to dry.
- If the back of the frame profile is not level when the assembly wedges are installed, it will create a gap in the front of the frame.
- A door stop or folded cardboard placed under the corner of the two frame pieces will level the frame for installation of the assembly wedges. This is not necessary for relatively flat profiles.

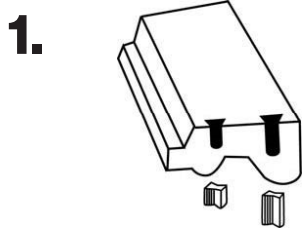

Match the length of assembly wedges to the depth of the routes.

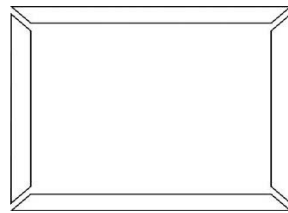

Before assembly, inspect the frame pieces for defects. Lay the four pieces face down.

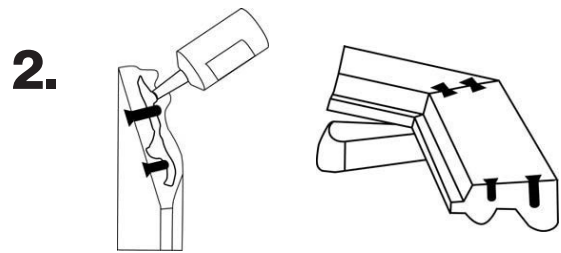

Choose a corner and apply glue to both pieces. With both glued pieces face down, level and align the corner and the routes. Depending on the profile, a door stop may be needed to level the frame.

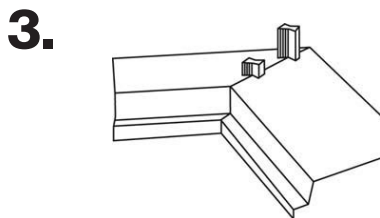

Holding the two corner pieces level and in place, insert both assembly wedges into the correct route. Insert the pointed end first. Tap the frame wedges flush with the back of the frame. Repeat for all corners.

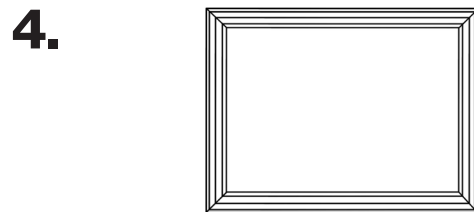
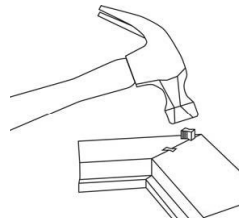

Turn over and inspect all corners. Wipe off excess glue with a damp cloth. Before the glue dries, if necessary, adjust the corners. One frame side may be higher than the other.

TROUBLESHOOTING (GAPS)

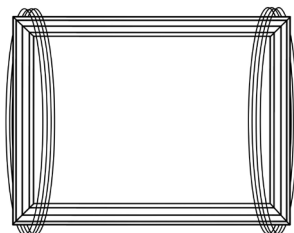

If necessary, a plastic shrink wrap can be used to pull all miters tight until the glue dries. Any excess glue that squeezes out on to the front of the frame can easily be picked off once the glue has fully dried.

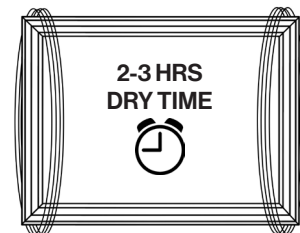

Please ensure that the glue is fully dry before attempting to install and glaze and mirror into the frames (this can cause the miters to open up if the glue is not fully dry). Allow at least 2-3 hours before installing mirror.